

NEW
SPACE-SAVING
SC70 PACKAGES

WORLD'S ONLY SC70 COMPARATOR + REFERENCE DRAWS ONLY 600nA FROM 1.8V

Space-Saving SC70 Package is 1/2 the Size of SOT23.
Ideal for 2-Cell Battery Monitoring in Portable Equipment

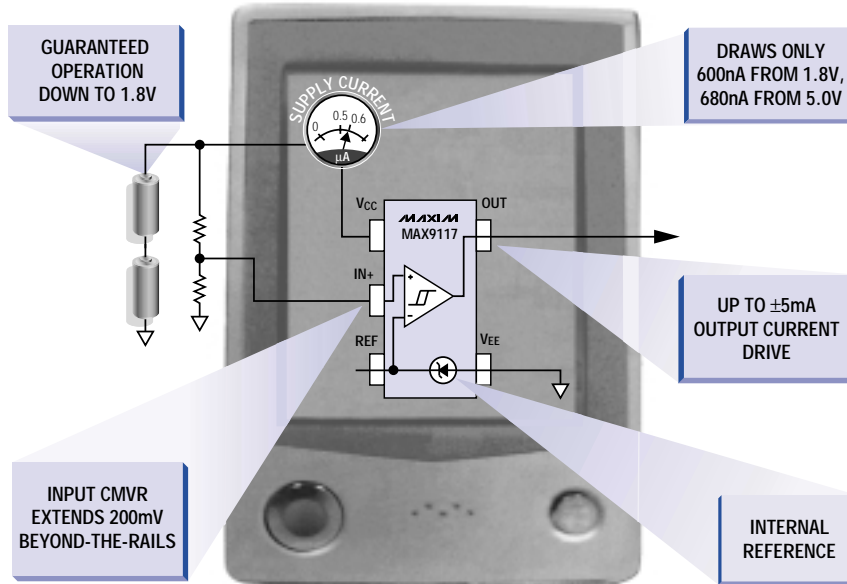

Choose the Best Nanopower Comparator for Your Portable Application

PART	NO. OF COMPARATORS	OUTPUT TYPE	1.252V ±1.75% INTERNAL REFERENCE	SUPPLY VOLTAGE RANGE (V)	SUPPLY CURRENT (µA)	RAIL-TO-RAIL® OUTPUT	BEYOND-THE-RAILS™ INPUTS	PIN-PACKAGE
MAX917/9117	1	Push/Pull	Yes	+1.8 to +5.5	0.60	Yes	Yes	5-SOT23/5-SC70
MAX918/9118	1	Open-Drain	Yes	+1.8 to +5.5	0.60	Yes	Yes	5-SOT23/5-SC70
MAX919/9119	1	Push/Pull	No	+1.8 to +5.5	0.38	Yes	Yes	5-SOT23/5-SC70
MAX920/9120	1	Open-Drain	No	+1.8 to +5.5	0.38	Yes	Yes	5-SOT23/5-SC70

Rail-to-Rail is a registered trademark of Nippon Motorola, Ltd. Beyond-the-Rails is a trademark of Maxim Integrated Products.



FREE Op Amps/Comparators Design Guide—Sent Within 24 Hours!
Includes: Reply Cards for Free Samples and Data Sheets

CALL TOLL-FREE 1-800-998-8800 for a Design Guide or Free Sample
6:00 a.m. – 6:00 p.m. Pacific Time

MAXIM
www.maxim-ic.com

2000 EDITION!
FREE FULL-LINE DATA CATALOG
ON CD-ROM



NEW! Get Price, Delivery, and Place Orders
Online at www.maxim-ic.com

Maxim Integrated Products, 120 San Gabriel Drive, Sunnyvale, CA 94086, (408) 737-7600, FAX (408) 737-7194.

Distributed by Maxim Distribution, Arrow, Avnet Electronics Marketing, CAM RPC, Digi-Key, Elmo, Nu Horizons, and Zeus.
Distributed in Canada by Arrow and Avnet Electronics Marketing.

MAXIM is a registered trademark of Maxim Integrated Products. © 2001 Maxim Integrated Products.